



Document 10-2135

Book 2 Page 719 Type 15 001 Pages 2

Date 6/02/2010 Time 12:43 PM

Rec Amt \$14.00

ARLENE SCHAUF, RECORDER/REGISTRAR
JACKSON COUNTY IOWA

Scott A. Steinfadt PLS, Ryken Engineering, 711 Park Avenue, Akley, Iowa 50801 - Ph. 641-847-3273 - Fax 641-847-2303

UNITED STATES PUBLIC LAND SURVEY CORNER CERTIFICATE

OF

Land Survey Monuments situated in Section 34, Township 85 North,
Range 6 East, of the Fifth Principal Meridian, Jackson County, Iowa,
Previously recorded in (see below) in County Recorder's Office
NW Corner, S $\frac{1}{4}$ Corner and NW Corner E $\frac{1}{2}$ NW $\frac{1}{4}$ - Not Applicable
N $\frac{1}{4}$ Corner - Book 2 Page 682

These corners were used for a survey in this section for Milton L. and Marion M. Daniels. Basis of bearing for this corner cert. can be found on the associated plot of survey filed in the Co. Rec's Office for this section.

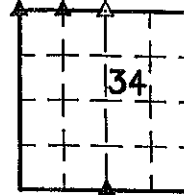

Legend

BC = Nail with Bottle Cap

BP = Brass Post

CP = Corner Post

CMP = Corrugated Metal Pipe

CM = 4" Sq Concrete Monument with

1/2" Iron rod in center (tie to rod)

CX = Cut 'X'

GP = Gale Post

ID = Inside Diameter

OD = Outside Diameter

PP = Power Pole

PW = Nail with Plastic Washer

RCP = Reinforced Concrete Pipe

RH = Red Head (Nail in wire)

ROW = Right of Way

RW = Nail with Reflective Round Washer

R/W = Iron ROW Roll

SFP = Steel 'T' Post

SW = Nail with Square Metal Washer

TP = Telephone Pedestal

TW = Nail with Round Metal Washer

WFP = Wood Fence Post

X = X Nails



NW Corner

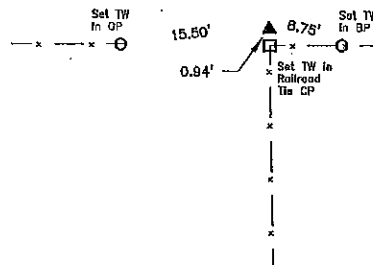

Monument Description, Remarks, and Plan View:

NW Corner - History of Corner =

1990, June 13 - "4" x 4" CONC. MONUMENT FOUND" per County Recorder's Book 1-G Page 45.

Current County Engineer's ties do not indicate that corner is monumented.

Corner Recovery =

Searched area with a tile probe and excavated a 1.0' x 0.5' deep hole at probed concrete. Found a 4" x 4" brass capped concrete monument (stamped '27', '28', '33', and '34'), 0.2' deep. Monument found is in-line with fence line South and 1.0'± North of fence line East - West. Location of monument found matches that of record and monument found matches that of record. Therefore, placed a MAG nail on West side of concrete monument below high point for locating purposes only and used concrete monument as the correct corner. All ties are plumb distance.

This certificate is being prepared because there are no certificates on file for this corner.

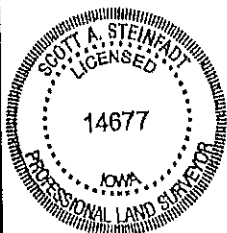

I hereby certify that this land surveying document was prepared and the related survey work was performed by me or under my direct personal supervision and that I am a duly licensed Land Surveyor under the laws of the State of Iowa.

Scott A. Steinfadt PLS

SCOTT A. STEINFADT, PLS

Date: 05/21/2010 License number: 14677

My license renewal date is December 31, 2010

Pages or sheets covered by this seal: 1, 2

List Corners to be Indexed

Corners	Section	Twp	Range
NW Corner	34	T85N	R6E
NW Cor. E $\frac{1}{2}$ NW $\frac{1}{4}$	34	T85N	R6E
N $\frac{1}{4}$ Corner	34	T85N	R6E
S $\frac{1}{4}$ Corner	34	T85N	R6E

Pg 1 of 2

\\Dasserver\projects\P1002-5052\CADD\Survey\5052Concert.dwg

Book 2 Page 719

NW Corner E $\frac{1}{2}$ NW $\frac{1}{4}$

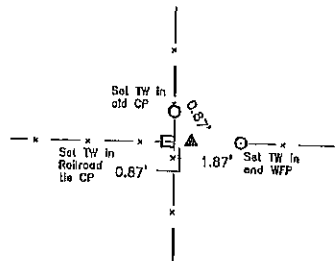

Monument Description, Remarks, and Plan View:

NW Corner E $\frac{1}{2}$ NW $\frac{1}{4}$ - History of Corner =
Current County Engineer's ties do not indicate that corner is monumented.

Corner Recovery =

Searched a 5' area at fenceline intersection with a tile probe and excavated a 3.0' x 2.0' x 1.2' deep hole at a probed stone. Found a flat topped 9" x 9" tan stone, 1.0' deep. Monument found is in-line with fenceline East - West and 1.0' East of fenceline North - South. Stone is upright and well nested, no other stones were found in the probed area and stone fits possession lines well. Therefore, placed a pink plastic cased magnet on the east side of stone below top for locating purposes only and used the center of flat top of stone as the correct corner. All ties are plumb distance.

This certificate is being prepared because there are no certificates on file for this corner.

S $\frac{1}{4}$ Corner

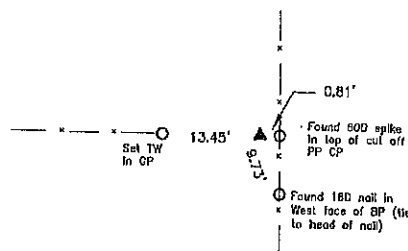

Monument Description, Remarks, and Plan View:

S $\frac{1}{4}$ Corner - History of Corner =
1931 - Iowa State Highway Commission Iowa Highway 52 Right of Way Plans and Improvement Plans obtained from I.D.O.T. District 6 Office indicates usage of corner, but not type of monumentation.

Current County Engineer's ties do not indicate that corner is monumented.

Corner Recovery =

Searched a 5' area around a cut off power pole corner post with a tile probe and excavated a 2.0' x 1.0' deep hole. Found a 4" x 4" brass capped concrete monument (stamped '3' and '34'), 0.5' deep. Monument found is in-line with fenceline West and 1.0' West of fenceline North - South. Location of monument found matches that of record and monument found is common for the area. Therefore, placed a pink plastic cased magnet on West side of monument for locating purposes only and used concrete monument as the correct corner. All ties are plumb distance.

This certificate is being prepared because there are no certificates on file for this corner.

N $\frac{1}{4}$ Corner

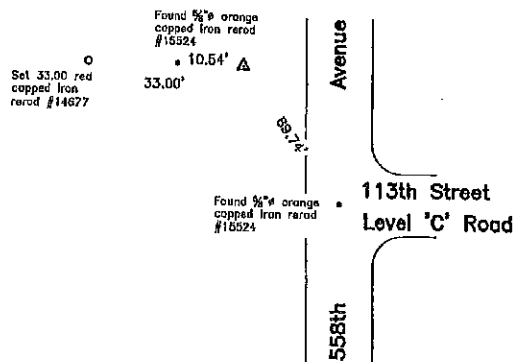

Monument Description, Remarks, and Plan View:

N $\frac{1}{4}$ Corner - History of Corner =

1877, June 8 - "Gr. Post" per County Road Record Book.

2009, Aug. 10 - "3/8" ROUND IRON ROD STAKE SET 52.0' EAST AND ON THE SOUTH LINE OF SE $\frac{1}{4}$ " By LS 15524 per County Recorder's Certificate Book 2 Page 682.

2009, Aug. 26 - "SET REFERENCE STAKE 52.00' EAST OF CORNER, TRUE CORNER IN RAVINE" per County Rec's Book 1-S Page 126.

2009, Sep. 10 - "SET REFERENCE STAKE 52.00' EAST OF CORNER, TRUE CORNER IN RAVINE" per County Rec's Book 1-S Page 128.

Current County Engineer's ties are the same as Corner Certificate found in County Recorder's Book 2 Page 682.

Corner Recovery =

Found the reference stake and SE Corner set by LS 15524 as shown on above referenced Certificate and calculated a position for the North $\frac{1}{4}$ Corner. This position did not fit possession line to the west. Therefore it was decided to locate the NW Corner of the E $\frac{1}{2}$ NW $\frac{1}{4}$ and the NW Corner of Section and calculate a position on-line and double the distance between said Corners to the east. While locating the stone at the NW Corner of the E $\frac{1}{2}$ NW $\frac{1}{4}$ LS 15524 arrived on site and indicated he was there to relocate the S $\frac{1}{4}$ Corner of Section 27 using fencelines west and north of said Corner. After locating the Concrete Monument at the NW Corner of Section 34 returned to the area of the N $\frac{1}{4}$ Corner and found LS 15524 setting a 3/8" Orange capped iron rod #15524 at the intersection of fencelines from the west and north. This monument was not accepted as it ignores found monuments to the west. Also the distance between the NE Corner and N $\frac{1}{4}$ Corner shown on the 1877 Survey is 163 rods 4 links (2692.14') matches very well with the distance of 2692.02' between the NW Corner and the calculated position. A 10' area around the calculated position was searched with a metal detector and only said 3/8" rod was found. Searched a 6.0' area with a tile probe around calculated position and hit a rock layer at 3.0' deep and found many broken pieces of concrete and brick that has been dumped off the side of 558th Avenue. Therefore since the position of said 3/8" rod was not accepted and no addition monument could be located, set a 3/4" x 4.0' aluminum capped iron rod (#14677) stamped '1/4 COR', '27', and '34' at calculated position, 1.0' exposed to perpetuate monumentation and used it as the correct corner. Monument set is 42.0' West of apparent centerline of traveled surface of gravel road North - South, in-line with fenceline West and corner was established using accepted PLSS methods. Also the distance between the NE Corner and N $\frac{1}{4}$ Corner-shown on the 1877 Survey is 163 rods 4 links (2692.14') matches very well with the distance between the NW Corner and the calculated position of 2692.02'. All ties are plumb distance.

This certificate is being prepared because a position different than that of record was accepted.

Legend

BC = Nail with Bottle Cap

BP = Brass Post

CP = Corner Post

CMP = Corrugated Metal Pipe

CM = 4" Sq Concrete Monument with

1/2" iron rod in center (tie to rod)

CX = Cut 'X'

GP = Gate Post

ID = Inside Diameter

OD = Outside Diameter

PP = Power Pole

PW = Nail with Plastic Washer

RCP = Reinforced Concrete Pipe

RH = Red Head (Nail in wire)

ROW = Right of Way

RW = Nail with Reflective Round Washer

R/W = Iron ROW Roll

SFP = Steel 'I' Post

SW = Nail with Square Metal Washer

TP = Telephone Pedestal

TW = Nail with Round Metal Washer

WFP = Wood Fence Post

X = X Nails



Document 21-3886

Type 15 001

Pages 1

Date 9/21/2021 Time 10:08 AM

Rec Amt \$7.00

ARLENE SCHAUF, RECORDER/REGISTRAR
JACKSON COUNTY IOWA

UNITED STATES PUBLIC LAND SURVEY CORNER CERTIFICATE

Land Survey Monuments Situated in Section 34, Township 85 North, Range 6 East of the Fifth Principal Meridian, Jackson County, Iowa.

Narrative:

Set a 1/2" rebar with #21753 orange survey cap for the center of section at the intersection point of the line between the found North and South 1/4 corners and the line between the found West and calculated East 1/4 corners Section 34 (from Plat of Survey recorded in Book 2016, Page 330), on the easterly edge of gravel 558th Ave. Corner not previously monumented.

Set a 1/2" rebar with #21753 orange survey cap for the Southwest corner of the East 1/2 of the NW Quarter on the South line of the Northwest Quarter midway between the found West 1/4 corner and the Center of Section 34. Corner not previously monumented.

